

© Copyright 2007  
 INTELLECTUAL PROPERTY OF WORLEYPARSONS LIMITED.  
 WITHOUT WARRANTIES, REPRESENTATIONS OR ANY  
 REFINEMENT OF COPYRIGHT & IS EXPRESSLY FORBIDDEN

- NOTES**
1. DIMENSIONS ARE IN MILLIMETRES UNLESS OTHERWISE STATED. COORDINATES AND ELEVATIONS ARE IN METRES.
  2. PLANT COORDINATES PN 100,0000 PE 100,0000 REFER TO STATE COORDINATES N 31655.7976 E 104277.2637
  3. ELEVATION EL. 100,000 REFERS TO LEVEL ABOVE XXX SEA LEVEL.
  4. CONTRACTOR SHALL CONTROL ALL DIMENSIONS AND LEVELS PRIOR TO COMMENCEMENT OF CONSTRUCTION.

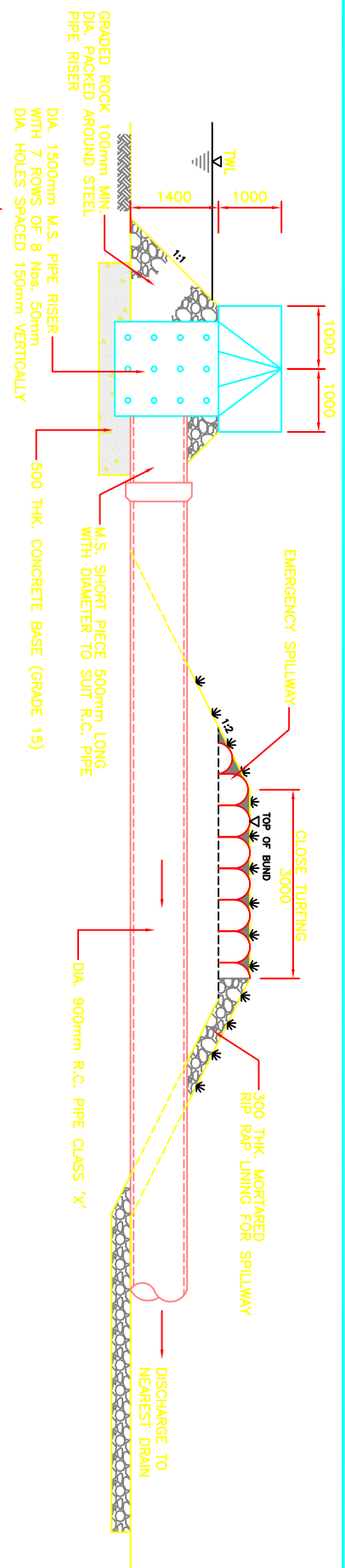

**SECTION 2-2**  
 SCALE 1 : 50

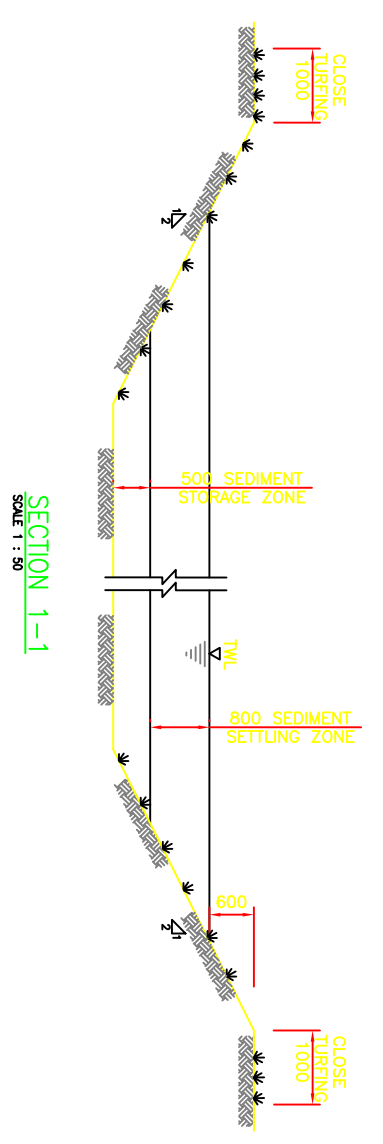

**SECTION 1-1**  
 SCALE 1 : 50

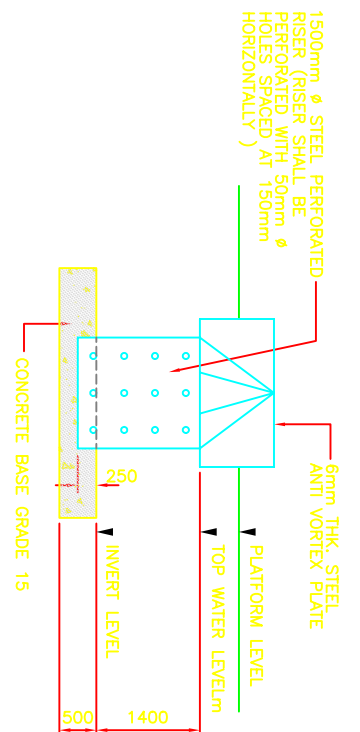

**DETAIL OF STEEL PERFORATED RISER**  
 SCALE 1 : 50

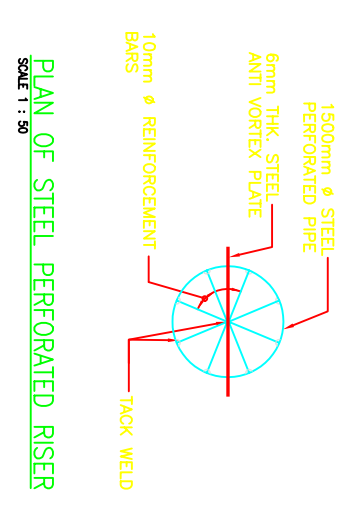

**PLAN OF STEEL PERFORATED RISER**  
 SCALE 1 : 50

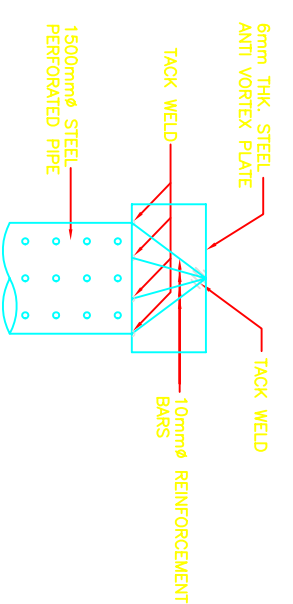

**TOP ELEVATION OF STEEL PERFORATED RISER**  
 SCALE 1 : 50

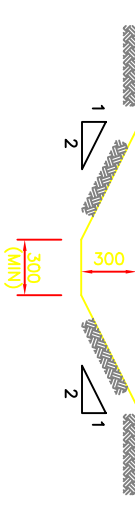

**TYPICAL SECTION OF EARTH DRAIN**  
 SCALE 1 : 20

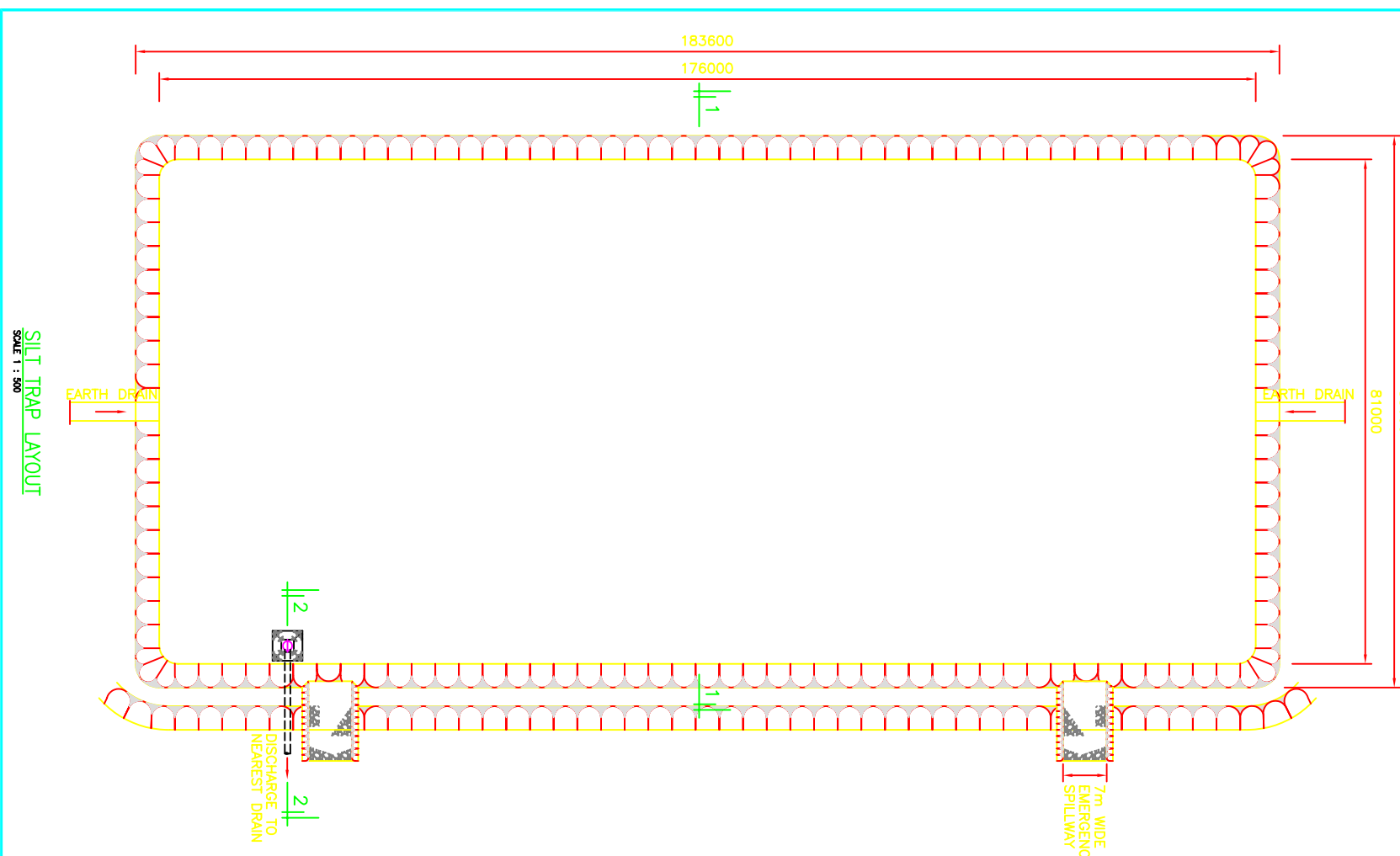

**SILT TRAP LAYOUT**  
 SCALE 1 : 500

REV	DATE	DESCRIPTION	ZUL	TCG	TL
0A	27/NOV/07	ISSUED FOR IFC			

**PROJECT:**  
 LYNAS ADVANCED MATERIALS PROJECT  
 CADANGAN PEMBANGUNAN PERINDUSTRIAN  
 DI ARAH LOT P18249 DAN P113637,  
 KAWASAN PERINDUSTRIAN GEBENG,  
 MUKIM SUNGAI KARANG, DAERAH KUANTAN,  
 PAHANG DARUL MAKMUR  
 UNTUK TELUK LYNAS MALAYSIA SDN BHD

**LAND/BUILDING OWNER:** Pemilik Tanah/Bangunan

**LYNAS MALAYSIA SDN BHD**  
 (subsidiary of)  
 PERBROS, RISAT PERINGKAM BUKIT KUANG 2,  
 BUKIT KUANG,  
 24000 KEDAH,  
 TERENGGANU DARUL IMAH,  
 TEL +60 9 638 4445  
 FAX +60 9 638 4449

**CONSULTANT:** Juniera Perunding



**PERUNDING RANHILL WORLEY SDN BHD**  
 (subsidiary of)  
 13th FLOOR, EMERGE TOWER, CITY SQUARE CENTRE  
 182 JALAN TUN RIZAK  
 50400 KUALA LUMPUR  
 TEL +60 3 2039 8888  
 FAX +60 3 2163 0924



PREPARED:	ZUL	CHECKED:	TCG	APPROVED:	TL
UNIT NO.		BUILDING NO.			
AREA:	GENERAL	DISCIPLINE:	CIVIL & STRUCTURAL	SCALE:	AS SHOWN
DRAWING TITLE:	EARTHWORK SILT TRAP DETAILS				
DRAWING NO.:	Exhibit 5.2.2	REV:	0A		